

PROFILE: PROPOSED ROBIN LANE
SCALE: HORIZONTAL 1"=50'
VERTICAL 1"=5'

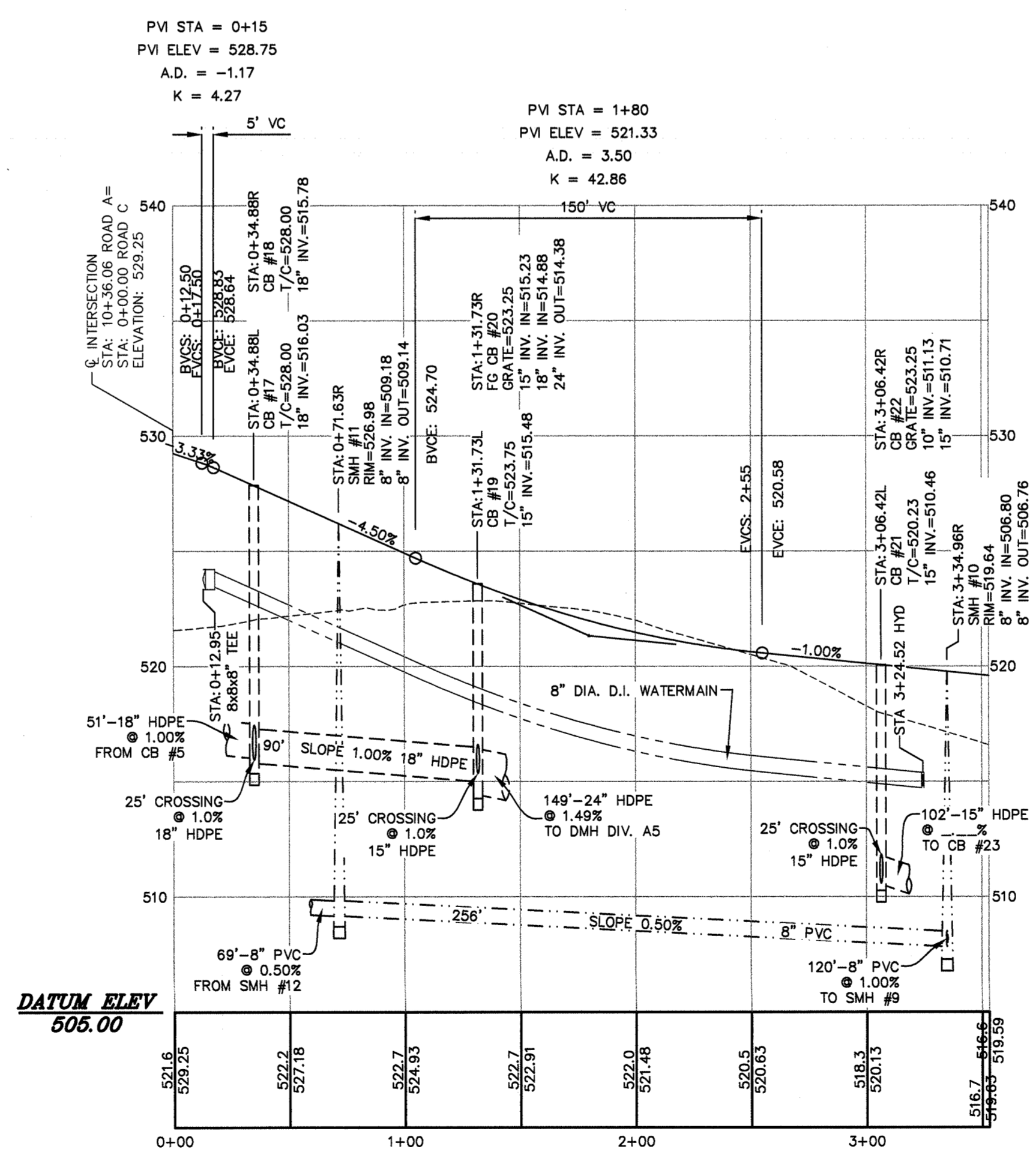

PROFILE: PROPOSED WILLIAM COURT
SCALE: HORIZONTAL 1"=50'
VERTICAL 1"=5'

COPIES FROM THE ORIGINAL OF THIS DOCUMENT NOT MARKED WITH AN ORIGINAL OF THE PROFESSIONAL ENGINEER'S AND/OR LAND SURVEYOR'S STAMP OR EMBOSSED SEAL SHALL NOT BE CONSIDERED VALID, TRUE COPIES.

UNAUTHORIZED ALTERATION OR ADDITION TO THIS DOCUMENT IS A VIOLATION OF SECTION 7209-2 OF THE NEW YORK STATE EDUCATION LAW.

LANC & TULLY
ENGINEERING AND SURVEYING, P.C.
P.O. Box 687, Rt. 207
Goshen, N.Y. 10924
(845) 294-3700

ROAD & UTILITY PROFILES-ROBIN LANE
& WILLIAM COURT PREPARED FOR
GLENMERE PRESERVE
VILLAGE OF FLORIDA
ORANGE COUNTY, NEW YORK

DATE: OCTOBER 8, 2012
REVISION: NOVEMBER 30, 2012

Drawn By: CDD
Checked By: AS NOTED
Scale: AS NOTED
Tax Map No.: 113-4-2.1,2,7,2.18
Drawing No.: A-04-0178-10

121210-020