

PROFILE: PROPOSED SEWER MAIN RUN:
 NYS ROUTE 17A TO SMH #10
 SCALE: HORIZONTAL 1"=50'
 VERTICAL 1"=5'

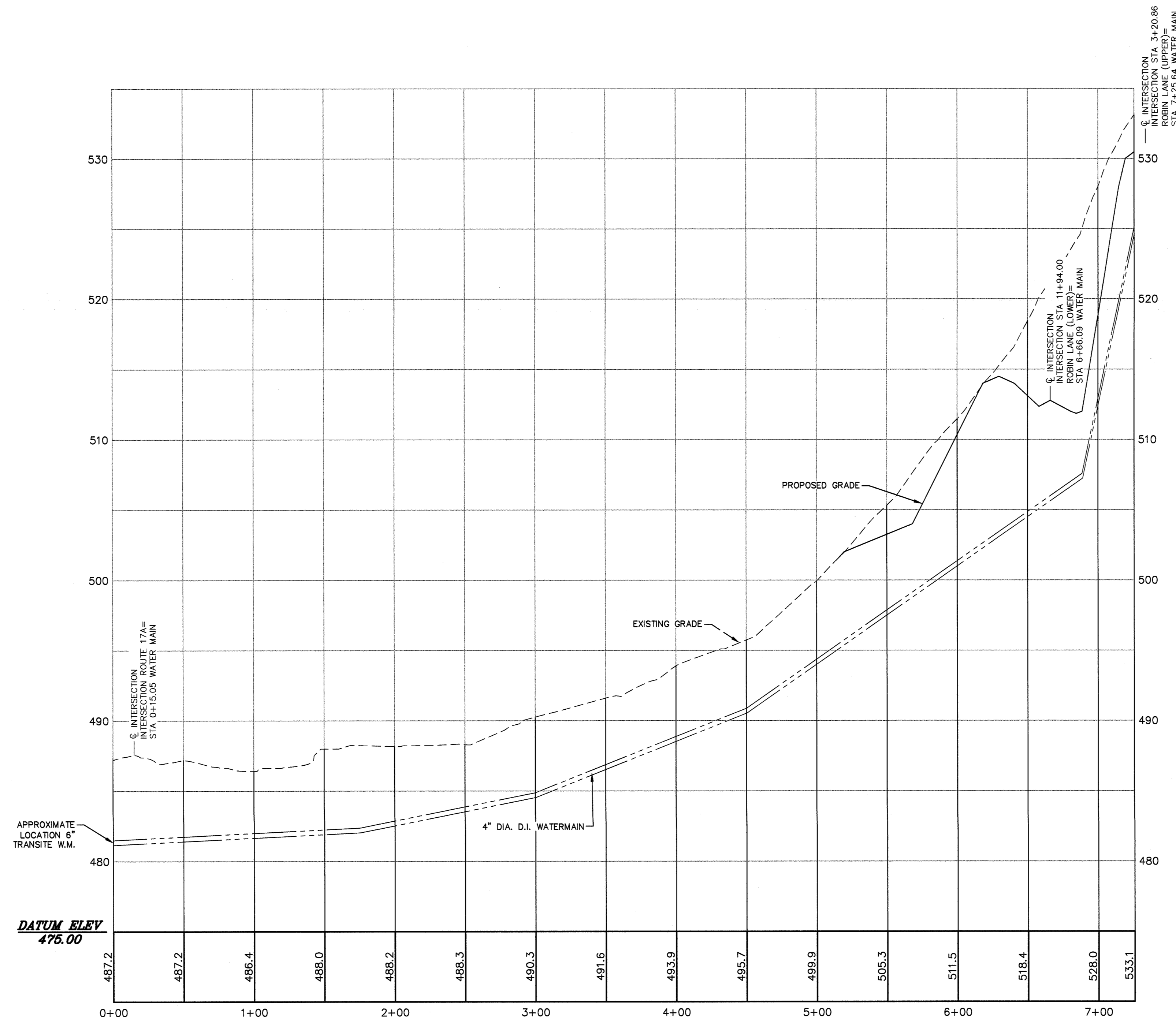

PROFILE: PROPOSED WATER MAIN RUN:
 NYS ROUTE 17A TO ROBIN LANE
 SCALE: HORIZONTAL 1"=50'
 VERTICAL 1"=5'

COPIES FROM THE ORIGINAL OF THIS DOCUMENT NOT MARKED WITH AN ORIGINAL OF THE PROFESSIONAL ENGINEER'S AND/OR LAND SURVEYOR'S STAMP OR EMBOSSED SEAL SHALL NOT BE CONSIDERED VALID, TRUE COPIES.

UNAUTHORIZED ALTERATION OR ADDITION TO THIS DOCUMENT IS A VIOLATION OF SECTION 7209-2 OF THE NEW YORK STATE EDUCATION LAW.

Copyright 2012, LANC & TULLY, P.C.

LANC & TULLY
 ENGINEERING AND SURVEYING, P.C.
 P.O. Box 687, Rt. 207
 Goshen, N.Y. 10924
 (845) 294-3700

DATE: OCTOBER 8, 2012
 REVISIONS: NOVEMBER 30, 2012

SEWER & WATER PROFILES
 PREPARED FOR

GLENMERE PRESERVE

VILLAGE OF FLORIDA
 ORANGE COUNTY, NEW YORK

Drawn By: [Signature] Checked By: [Signature] Scale: AS NOTED Tax Map No.: 113-4-2.1,2,2.7,2.16 Drawing No.: 11 OF 18

Sheet No.: 11 OF 18

A-04 - 0178 - 11